

**Key Lock and
general installation**

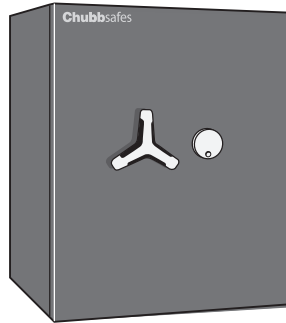

**E-Lock S&G
Titan D-Drive**

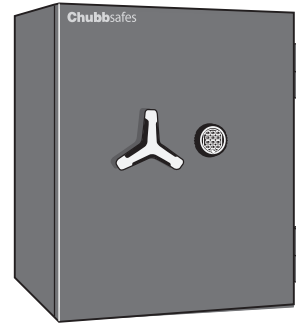

**Key Lock and E-Lock
S&G Titan D-Drive**

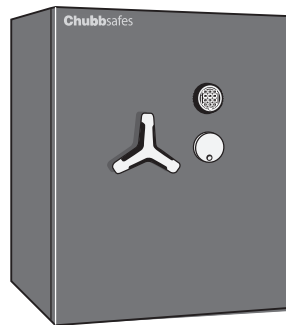

**Key Lock and Dial
Combination Lock S&G**

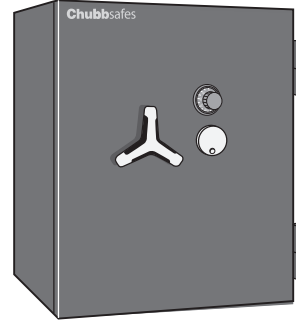

Chubbsafes
Trusted the world over.

www.chubbsafes.com

'Chubb' is owned by Chubb plc and is a registered trademark used under license



Key Lock and general installation

Page 3



E-Lock S&G Titan D-Driven

Page 4



Key Lock and E-Lock S&G Titan D-Drive

Page 5



Key Lock and Dial Combination Lock S&G 6642

Page 6

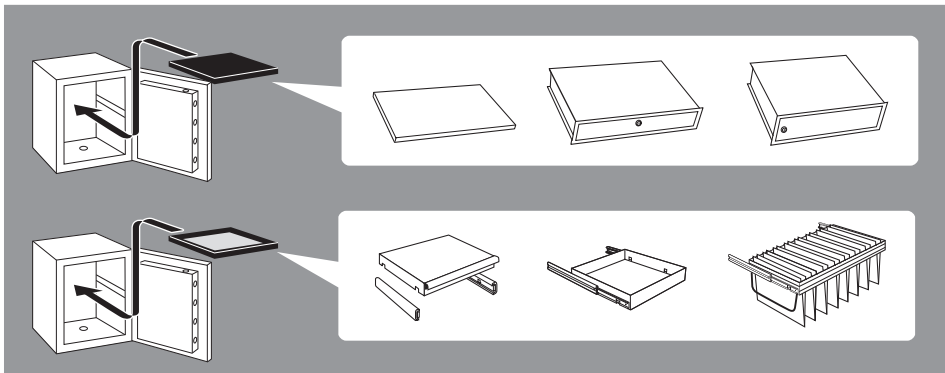

Page 7-8

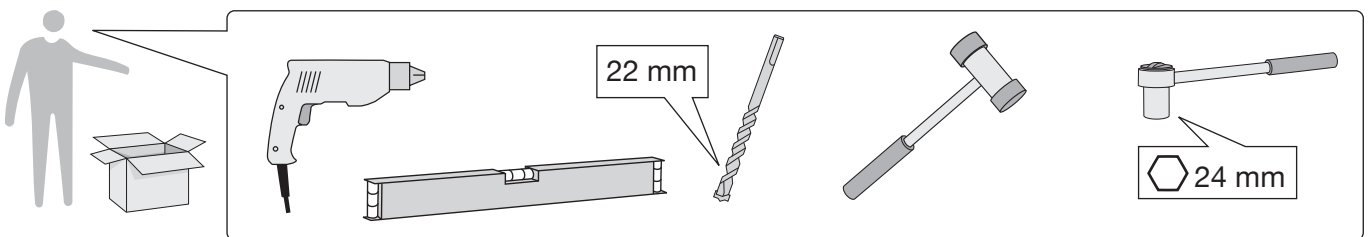
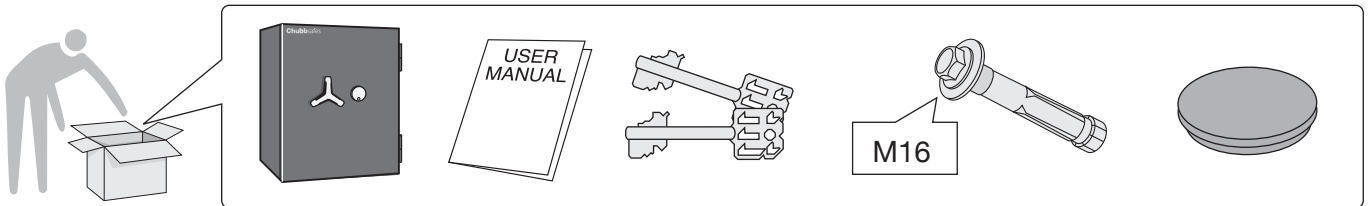

Key Lock and general installation

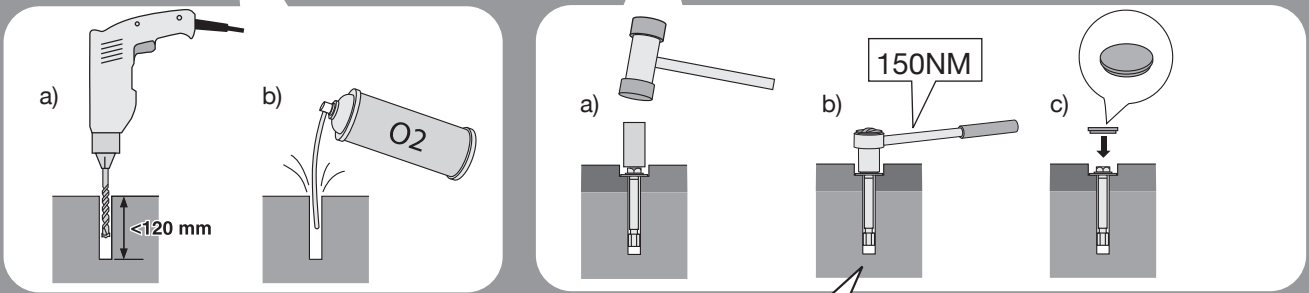
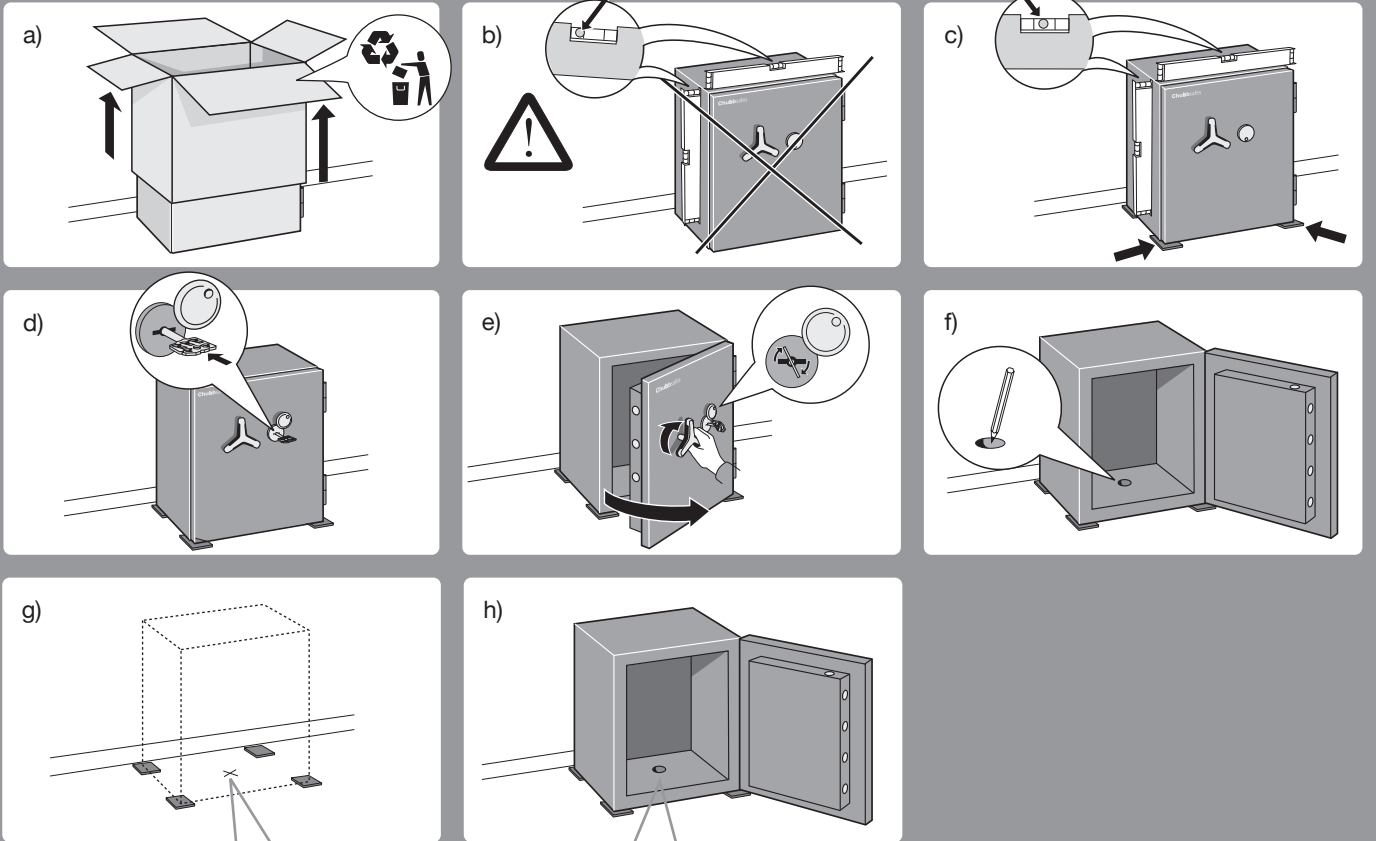
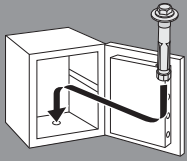

GB. IMPORTANT:
For a compliant fixing, the expansion bolt supplied with the safe must be fixed in a concrete compressive support of 250 MPa and the tightening torque must be of 150 Nm.

IT. IMPORTANTE:
Per un fissaggio conforme, il bullone di espansione in dotazione con la cassaforte deve essere fissato su un supporto compresso di calcestruzzo a 250 MPa con una coppia di serraggio di 150 Nm.

RU. ВАЖНО:
Болт распорный, входящий в комплект сейфа, в соответствии с фиксацией должен быть механически закреплён в бетон по прочности на сжатие до 250 МПа, и момент затяжки болта должен быть 150 Нм.

FI. TÄRKEÄÄ:
Jotta kiinnitys olisi asianmukainen, kassakaapin mukana toimitettu levytysovuli on kiinnitettävä 250 MPa:n betoniin puristustukeen ja kiristysmomentin on oltava 150 Nm.

FR. IMPORTANT:
Pour une fixation conforme aux normes, la cheville de fixation fournie avec le coffre doit être fixée dans un support en béton présentant une compression de 250 MPa en appliquant un couple de serrage de 150 Nm.

ES. IMPORTANTE:
Para obtener una fijación conforme, se debe fijar el perno de expansión suministrado con la caja en un soporte de compresión de hormigón de 250 MPa, mientras que el par de apriete debe ser de 150 Nm.

SE. VIKTIG:
För godkänd förankring måste den medföljande expanderbulten fästas i ett betongstöd med en kompressionshållfasthet på 250 MPa och åtdragningsmomentet måste vara 150 Nm.

ملحوظة هامة:
للحصول على تثبيت مطابق للمواصفات، يجب تثبيت مسامير التثبيت المرفقة مع الصندوق في دعامة إسمنتية ذات قوة ضغط 250 ميجا باسكال ويجب أن يكون عزم التثبيت 150 نيوتن متر.

DE. WICHTIG:
Für eine normenkonforme Befestigung müssen die mit dem Safe gelieferten Bolzen in einer Betondruckhalter von 250 MPa befestigt werden und der Anzugsmoment muss 150 Nm betragen.

PT. IMPORTANTE:
Para uma fixação conforme, o chumbador de unha fornecido com o cofre deve ser fixado num suporte compressivo de betão de 250 MPa e o binário de aperto deve ser de 150 Nm.

NO. VIKTIG:
For godkjent innfesting må ekspansjonsboltene som leveres med safen festes i betong med en kompresjonsstyrke på 250 MPa og et tiltrekingsmoment på minst 150 Nm.

ID. PENTING:
Untuk memperbaikinya, baut ekspansi disertakan dengan aman harus tetap dalam dukungan tekanan beton 250 MPa dan torsi pengencangan harus di 150 Nm.

NL. BELANGRIJK:
Voor een conforme installatie moet de bij de safe geleverde expansiebolten bevestigd worden in een betonnen druksteun van 250 MPa met een aanhaalmoment van 150 Nm.

PL. IWAŻNE:
Aby montaż był poprawny, śruby rozporowe dostarczone razem z sejfem należy wprowadzić do betonowej podstawy odpornej na nacisk 250 MPa; moment dokręcenia musi wynosić 150 Nm.

DK. VIGTIGT:
For at pengeskabet er fastgjort korrekt, skal den medfølgende ekspansionsbolt være fastgjort i et betonunderlag med et tryk på 250 MPa, og tilspændingsmomentet skal være 150 Nm.

CN. 重要信息:
为了符合锚固要求，随保险柜提供的膨胀螺栓必须固定在具有 250 MPa 压缩支持力的混凝土面上，拧紧力矩必须为 150 Nm。

E-Lock S&G Titan D-Drive

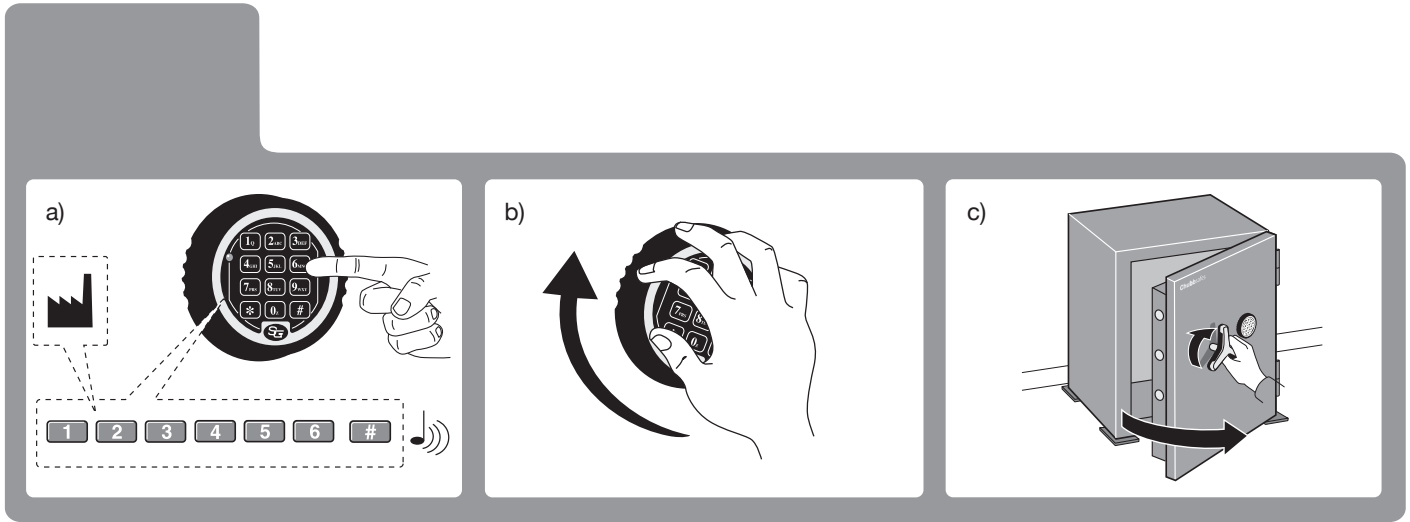

Key Lock and E-Lock S&G Titan D-Drive

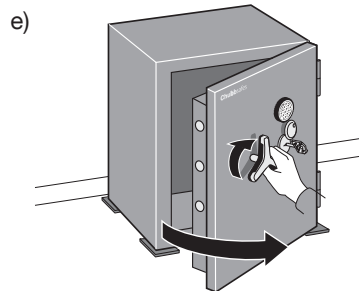
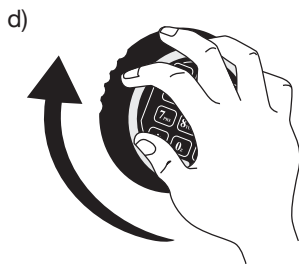
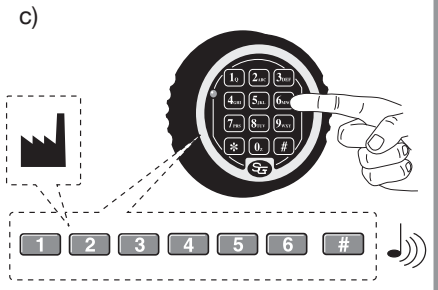
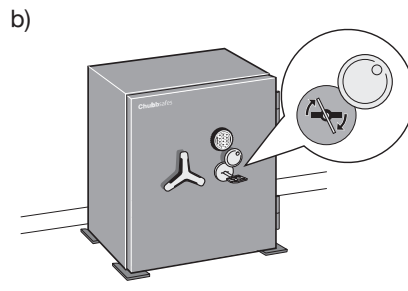
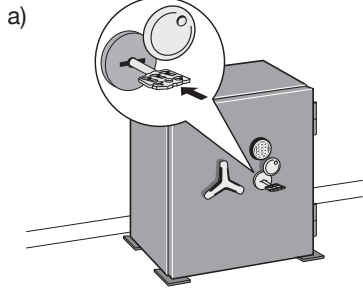

Key Lock and Dial Combination Lock S&G 6642

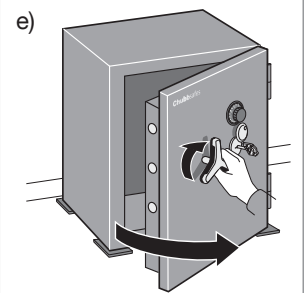
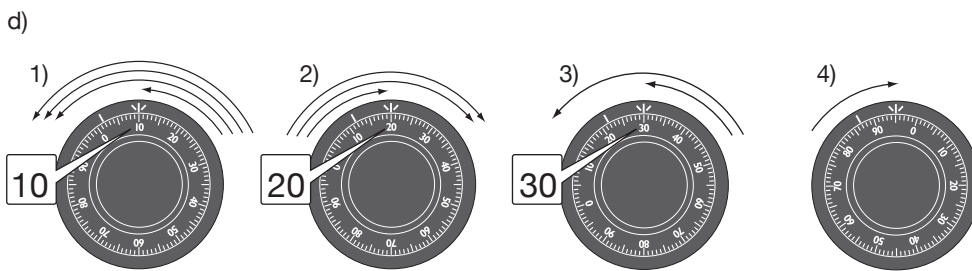
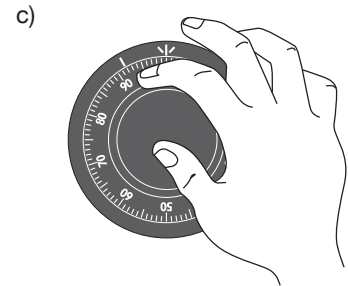
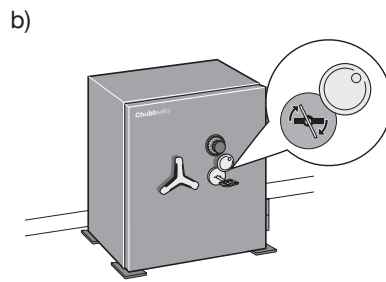
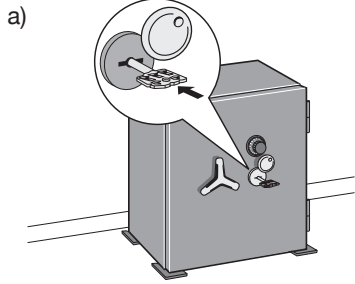

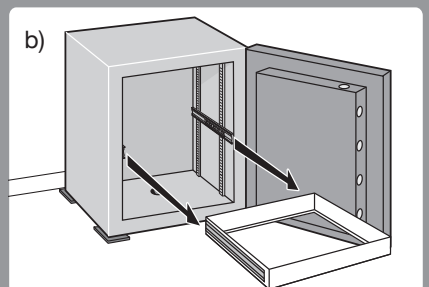
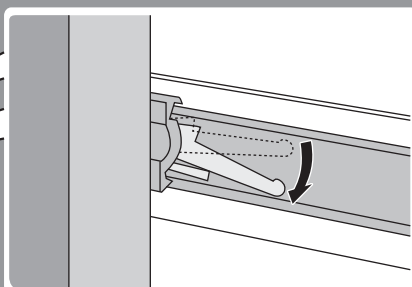
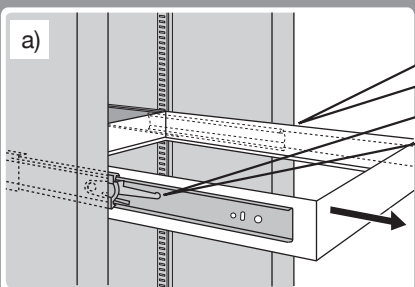
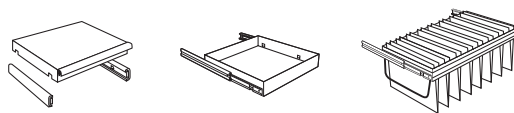
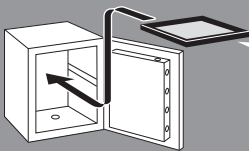
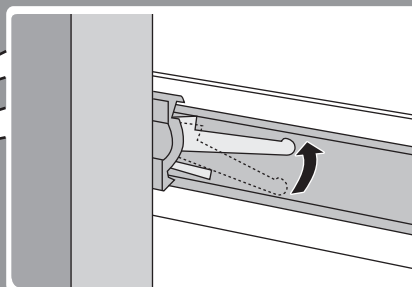
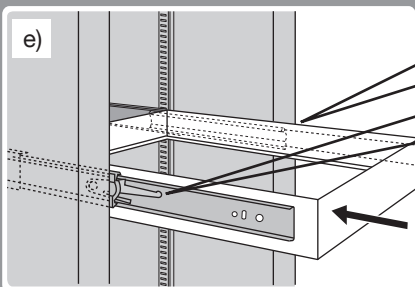
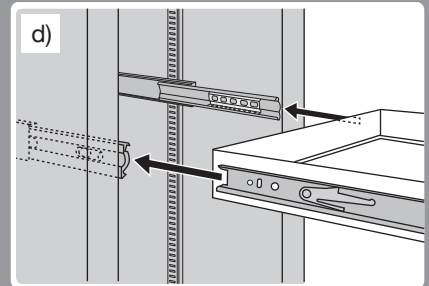
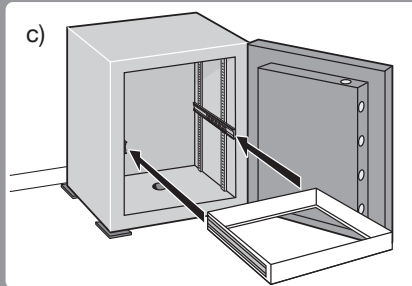
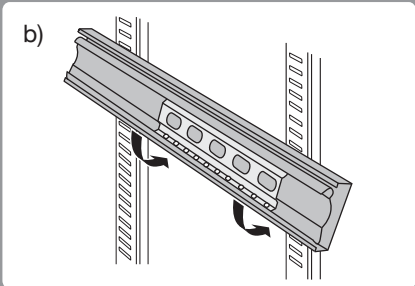
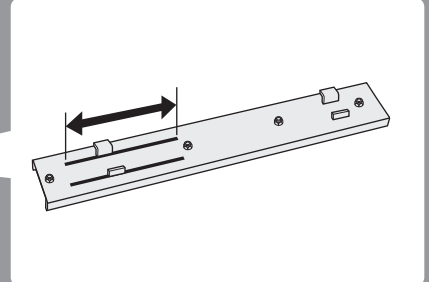
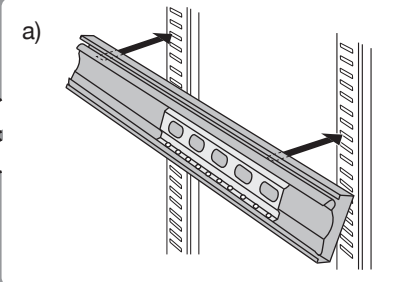
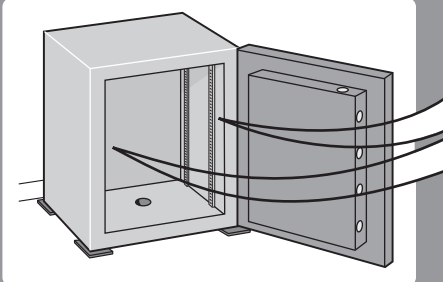
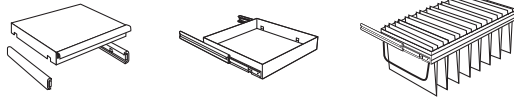
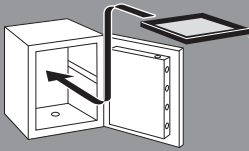

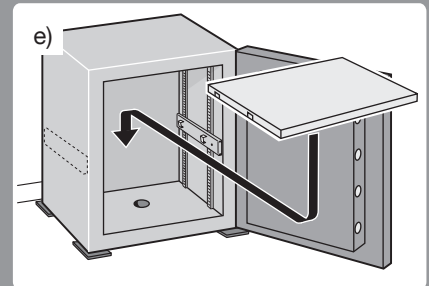
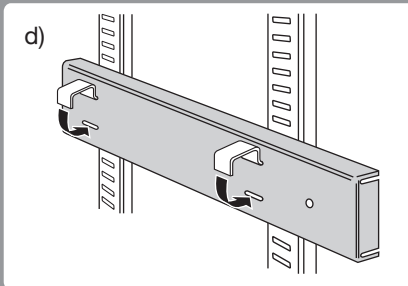
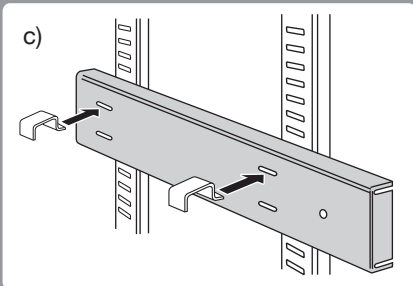
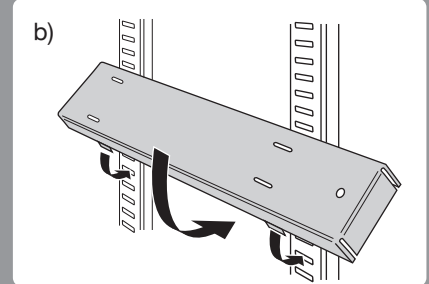
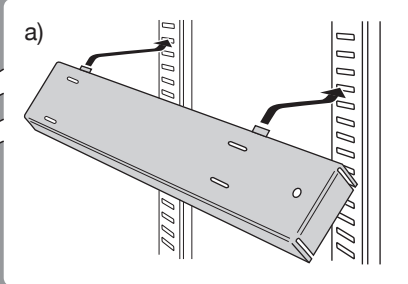
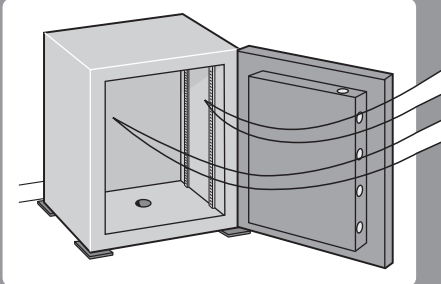
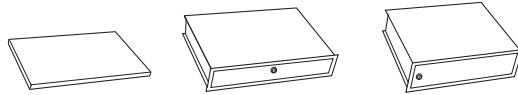
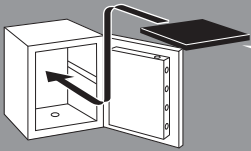

Chubbsafes
Trusted the world over.

www.chubbsafes.com

'Chubb' is owned by Chubb plc and is a registered trademark used under license